

Dieppe, New Brunswick

330 & 355 Dieppe Blvd.



Property Highlights

- Dieppe's tax base has tripled since 2000
(source: Economic Development Corporation of the City of Dieppe, NB)
- Area has a large variety of commercial businesses including: restaurants, food stores, hotels, professional services, retail stores, and fitness centres
- Dieppe Blvd. is a key traffic artery located in the northeast area of Dieppe

Dieppe, New Brunswick

330 & 355 Dieppe Blvd.

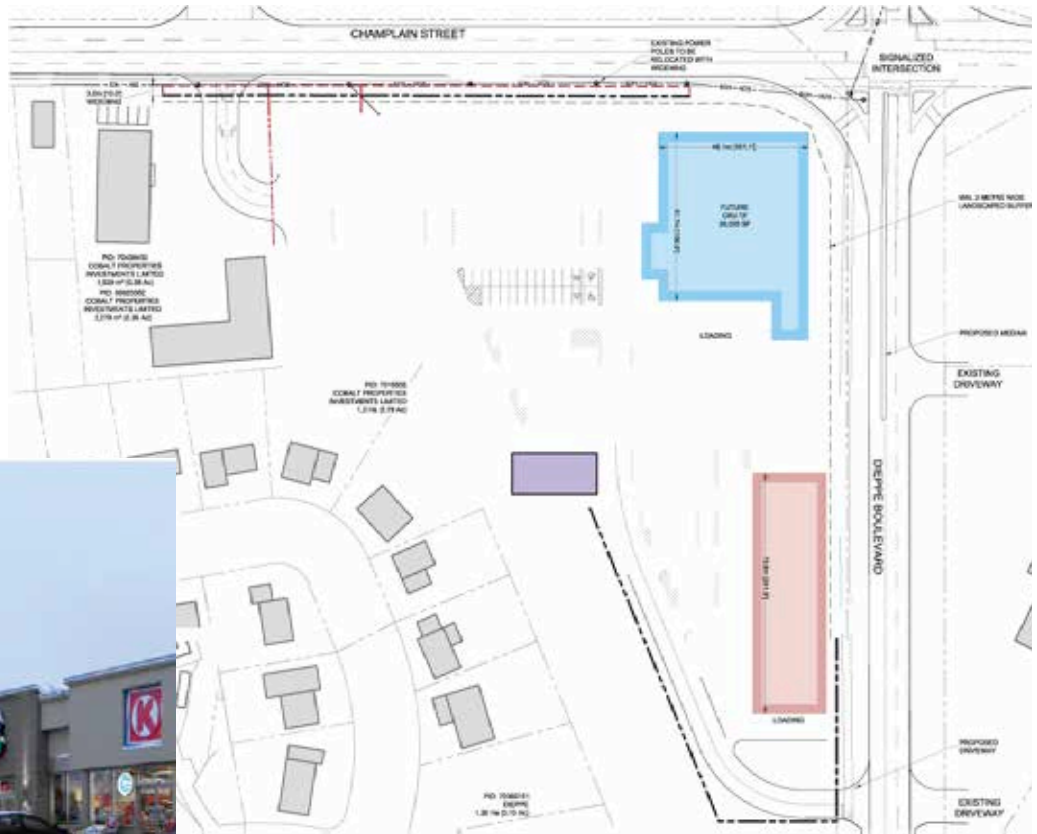

Project Details

Property ID: 70206834, 70168141, 70438542, 7018750, 500925362

Site Area: Approx. 9.5 acres +/-

Tenants of our properties include:

BMO, Subway, McDonald's, Tim Hortons, Canadian Tire, Dunkin' Donuts, Carquest, Dairy Queen, Circle K, A&W, Quizno's, Rogers, NL Liquor Corporation, Coast Tire & Auto, Thrifty Car Rental, Canada Post, Couche-Tard, Hogan Tire, CAT Scale, TD Bank, Harvey's, Pharmasave, Sleep Country, Pita Pit

Irving Oil is a privately owned regional refining and marketing company with a history of long-term partnerships and relationships. Our company offers significant holdings in Quebec, Atlantic Canada, and New England. With a portfolio that consists of prime real estate locations off major exits, our properties are ideal for fast food and quick service industries.

Marc Gosselin
506.202.2209
marc.gosselin@irvingoil.com

Susan Baxter
506.-202.7245
susan.baxter@irvingoil.com

